

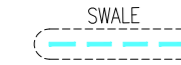

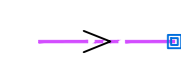



NOTES:

- DO NOT SCALE. USE FIGURED DIMENSIONS ONLY.
- THIS DRAWING IS TO BE READ IN CONJUNCTION WITH ALL OTHER RELEVANT ARCHITECTURAL AND ENGINEERING DRAWINGS.

LEGEND:

-  PROPOSED SWALE WITH PERFORATED PIPE
-  PROPOSED FILTER DRAIN
-  PROPOSED PERMEABLE PAVING
-  UNDERGROUND STORMTECH ATTENUATION STORAGE
-  PROPOSED GREEN ROOF
-  PROPOSED BIO-RETENTION TREE PIT
-  PROPOSED KERB INLET

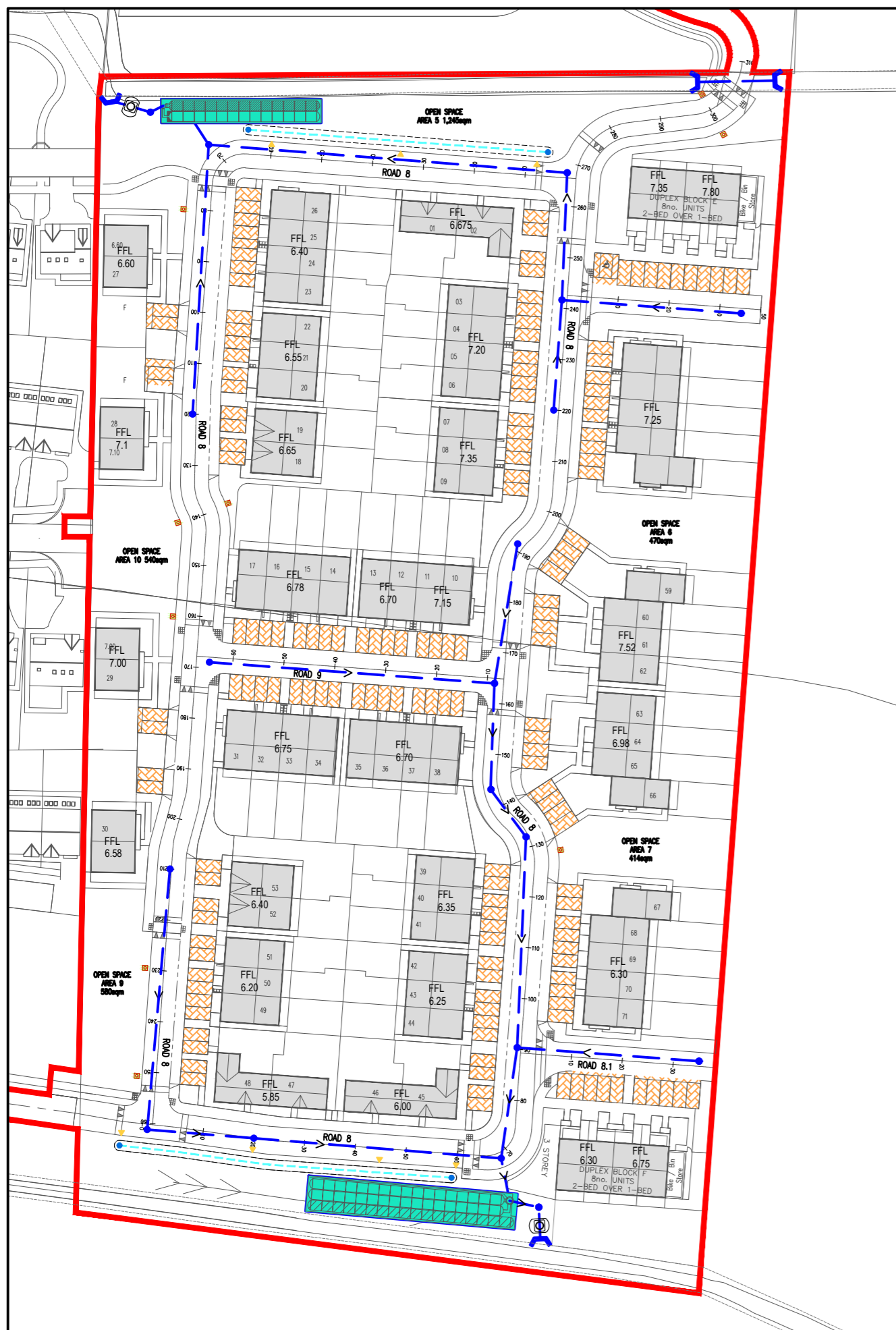
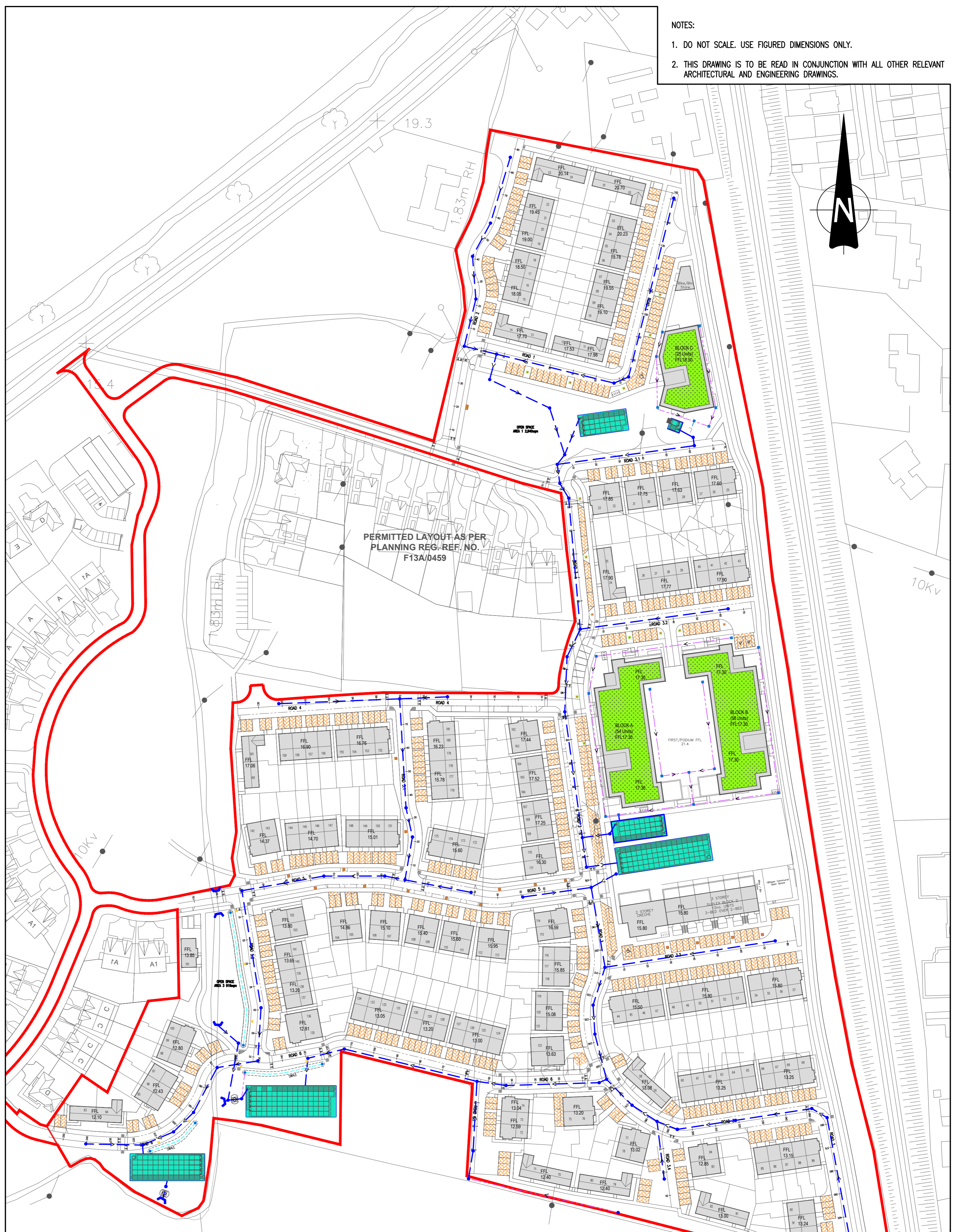

SOUTHERN SITE PLAN

SCALE 1:1000

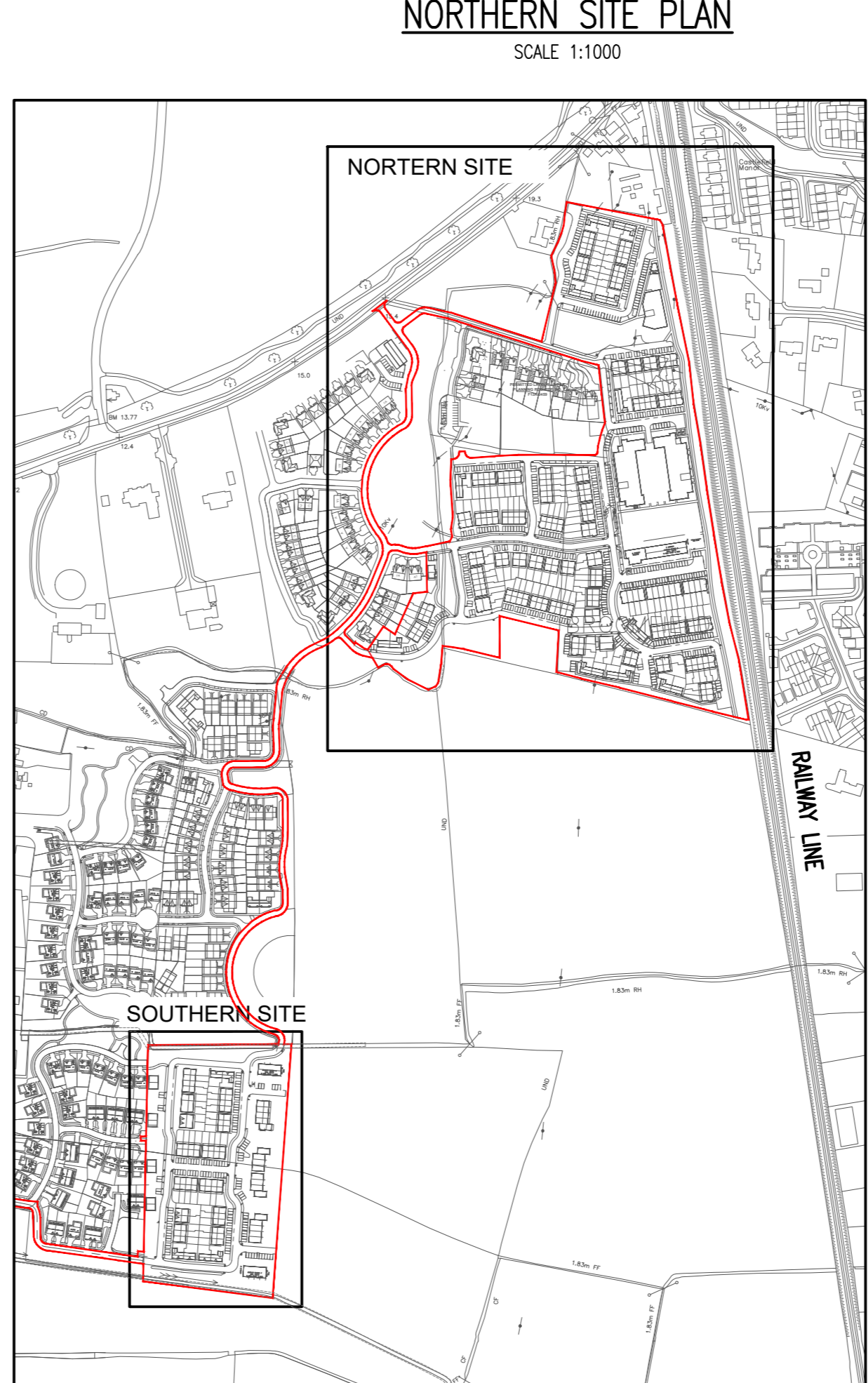

KEYPLAN PLAN

SCALE 1:5000

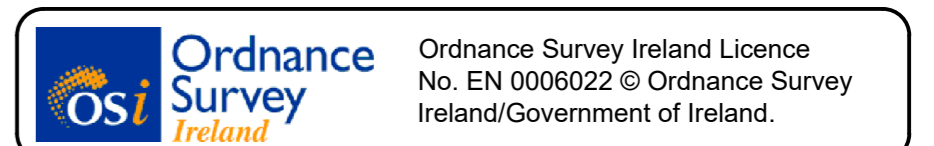
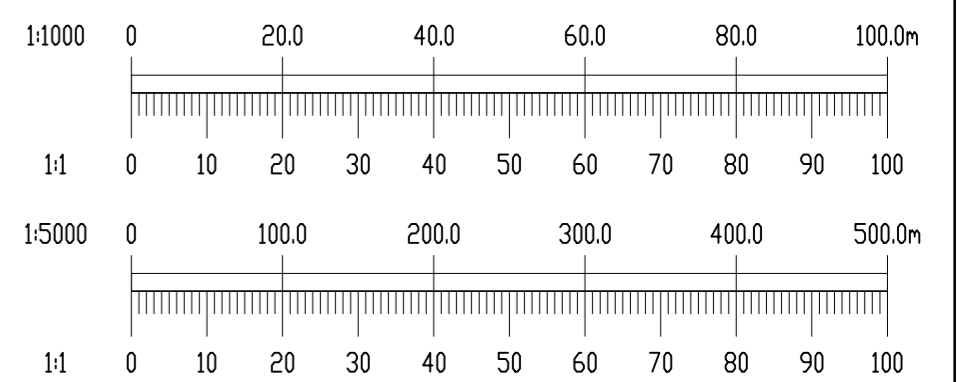

A	11/04/22	FINAL SHD SUBMISSION	PJD	MD
REV.	DATE	AMENDMENT	DRN	APPD

STATUS **FOR PLANNING NOT FOR CONSTRUCTION**

Waterman Moylan
Engineering Consultants
BLOCK 5, EASTPOINT BUSINESS PARK, ALFIE BYRNE ROAD, DUBLIN D03 H3F4 IRELAND.
Tel: (01) 664 8900 Fax: (01) 661 3618
Email: info@waterman-moylan.ie www.waterman-moylan.ie

CLIENT **BIRCHWELL DEVELOPMENTS LTD**
ARCHITECT **MCCROSSAN O'ROURKE MANNING ARCHITECTS**
PROJECT **BROOMFIELD SHD**
TITLE **SuDS LAYOUT**

DRAWN	DESIGNED	APPROVED	DATE
RW	RW	MD	NOV '20
SCALE	JOB NO.	DRG. NO.	REVISION
AS SHOWN @ A1	18-091	P235	A